



## Cell-Max™ Omni In-building Antenna, 698–960 MHz and 1710–2700 MHz

- This product is part of the CommScope Wired for Wireless® Solution

### OBSOLETE

This product was discontinued on: July 31, 2021

#### Replaced By:

CELLMAX-O-CPUSEW    Cell-Max™ Omni In-building Antenna, 698–960 MHz ,1695–2700 MHz and 3100-4200MHz

## Product Classification

Product Type	In-building antenna
Product Brand	Cell-Max™

## General Specifications

Application	Indoor
Antenna Type	Omni
Antenna Array Characteristic	SISO
Polarization	Vertical
Color	White (RAL 9016)
Mounting	Thru-hole ceiling mount (optional)
Number of Ports	1
Pigtail Cable	KSR195, plenum rated
Radome Material	ABS
RF Connector Interface	N Female

## Dimensions

Height	85 mm   3.346 in
Pigtail Length	315 mm   12.402 in

**Outer Diameter** 186 mm | 7.323 in

Outline Drawing

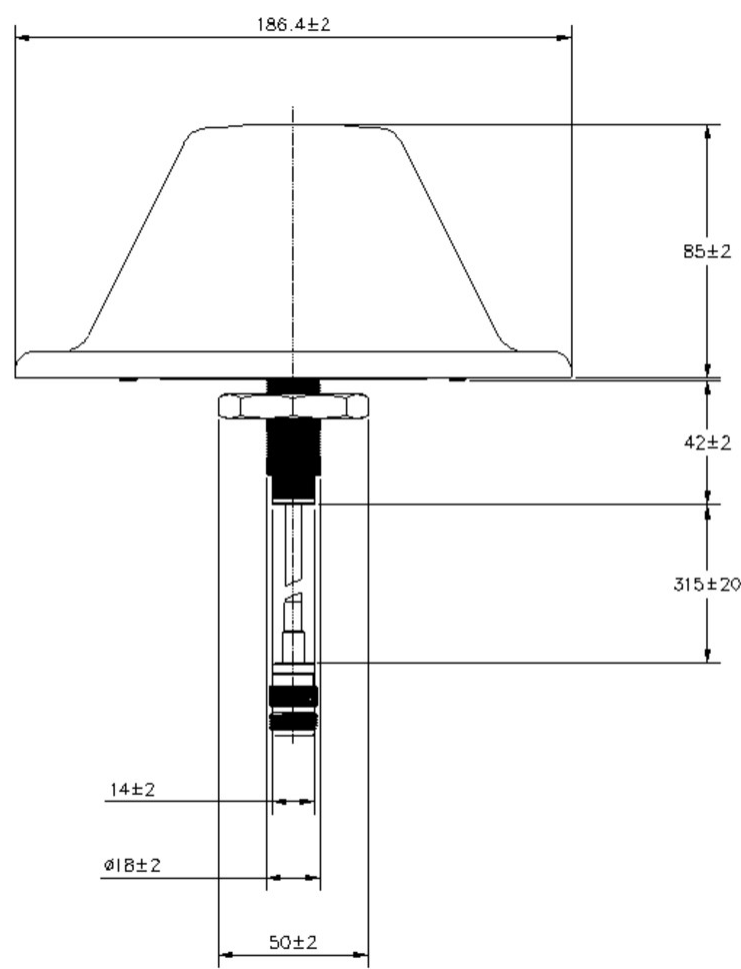

Electrical Specifications

Impedance	50 ohm
Operating Frequency Band	1710 – 2700 MHz   698 – 960 MHz

Electrical Specifications

Frequency Band, MHz	698–800	800–960	1710–2700
Gain, dBi	2	2	5
Beamwidth, Horizontal, degrees	360	360	360
VSWR   Return loss, dB	1.8   10.9	1.5   14.0	1.5   14.0
Input Power per Port, maximum, watts	50	50	50

## Environmental Specifications

<b>Operating Temperature</b>	-40 °C to +60 °C (-40 °F to +140 °F)
<b>Relative Humidity</b>	Up to 100%

## Packaging and Weights

<b>Height, packed</b>	135 mm   5.315 in
<b>Width, packed</b>	195 mm   7.677 in
<b>Length, packed</b>	195 mm   7.677 in
<b>Packaging quantity</b>	1
<b>Weight, gross</b>	0.4 kg   0.882 lb
<b>Weight, net</b>	0.3 kg   0.661 lb

## Regulatory Compliance/Certifications

<b>Agency</b>	<b>Classification</b>
CHINA-ROHS	Below maximum concentration value
ISO 9001:2015	Designed, manufactured and/or distributed under this quality management system
ROHS	Compliant

