

## RSB Cleat

Cleat for RSB Clip

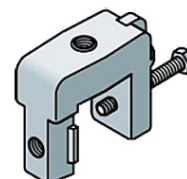

### Technical Features

#### GENERAL SPECIFICATIONS

Product Line		Coaxial Cable Accessories Elliptical Waveguide Accessories
Product Type		Hanger
Hanger Type		RSB Cleat
Installation Hardware Type		RSB Cleat
Cable Type		Coaxial Foam Dielectric

#### MECHANICAL SPECIFICATIONS

Number of Cable / Waveguide Runs		1
Angle member adapter clamping range	mm (in)	1 / 25 (0.039 / 0.9 )
Angle member adpter threads		2x M8
Material		Cleat: Aluminium Screw: Stainless Steel

#### TEMPERATURE SPECIFICATIONS

Installation Temperature	°C (°F)	-50 to 85 (-58 to 185 )
Operation Temperature	°C (°F)	-50 to 85 (-58 to 185 )
Storage Temperature	°C (°F)	-50 to 85 (-58 to 185 )

#### PACKAGING INFORMATION

Package Quantity		10
------------------	--	----

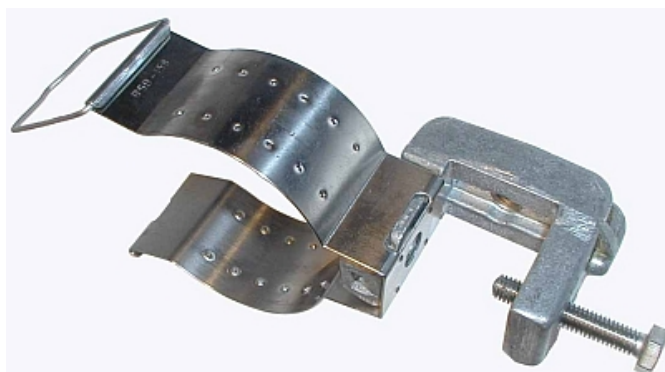

RSB-310\_Image.jpg

#### External Document Links

#### Notes