

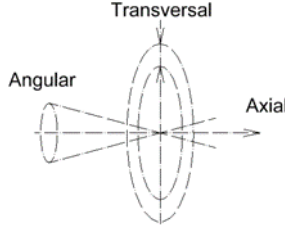

| General technical data | | |
|---|---|---|
| Frequency range | DC to 6 GHz | |
| VSWR, max. | 1.02 @ DC to 2 GHz | 1.06 @ 2 to 6 GHz |
| Intermodulation (IM3) 2x20 W max. | -162 dBc (for first 5,000 ¹⁾ matings) ²⁾ | |
| Ambient temperature range | +5 °C to +40 °C (indoor) | |
| Misalignment corrections ³⁾ | | |
| Transversal | ±2 mm |  |
| Axial | 6 mm | |
| Angular | ±1.5° | |
| Contact force during measurement, approx. | 80 N (at stroke 2 mm) | |
| Required stroke during measurement | 1.5 mm to 6 mm | |
| Latching | non-locking | |
| Matings | 10,000 ¹⁾ | |
| Inner conductor material / surface finish | CuBe age hardened / gold plated copper alloy / gold plated | |
| Outer conductor material / surface finish | copper alloy / gold plated CuBe / gold plated | |
| Other metal parts / surface finish | copper alloy / CuSnZn plated stainless steel / untreated copper alloy / nickel plated | |
| Insulation | LCP cross linked polystyrene PTFE | |

1) In order to ensure best possible measurement result, cleaning has to be assessed and executed by professional staff on a regular basis.

2) EasyDock is only released for IM measurement if interfaces on both ends are either 7-16 or 4.3-10

3) Values for misalignments might vary in case multiple misalignments have to be adjusted at the same time.

Sales article numbers

| Coaxial adapter EasyDock non-locking | Measurement interface | Rear interface | Mounting | Extra features |
|---|--------------------------|----------------|----------|----------------------------|
| CAEN | X | Z | X | -Z |
| 7-16 male push-pull | 7MP | | | Blank if not applicable |
| 4.3-10 male push-pull | 43MP | | | |
| 4.1-9.5 male push-pull | 41MP | | | |
| N male push-pull | NMP | | | |
| 7-16 female | | 7F | | Blank if not applicable |
| 4.3-10 female | | 43F | | |
| N female | | NF | | |
| 3.5 mm female | | 35F | | |
| Bulk head | | | B | Blank if not applicable |
| Panel four hole | | | P | |
| Screening effectiveness (only for 7-16 measurement interface) | | | | S |

Examples:

CAEN-7MP-43F-B-S (Coaxial adapter EasyDock non-locking, 7-16 male push-pull, 4.3-10 female, bulk head, screening effectiveness)

CAEN-NMP-NF-P (Coaxial adapter EasyDock non-locking, N male push-pull, N female, panel four hole)

Panel mounting dimensions

Panel four hole

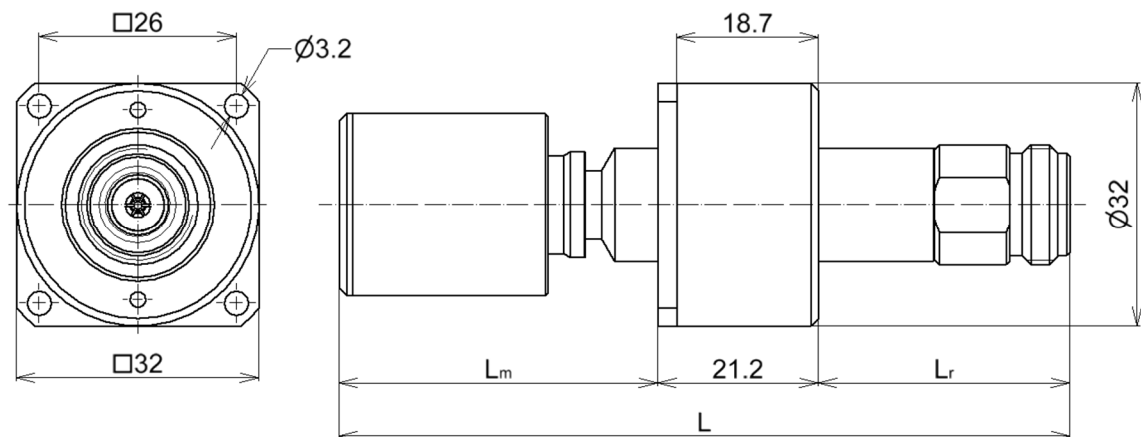

Bulkhead

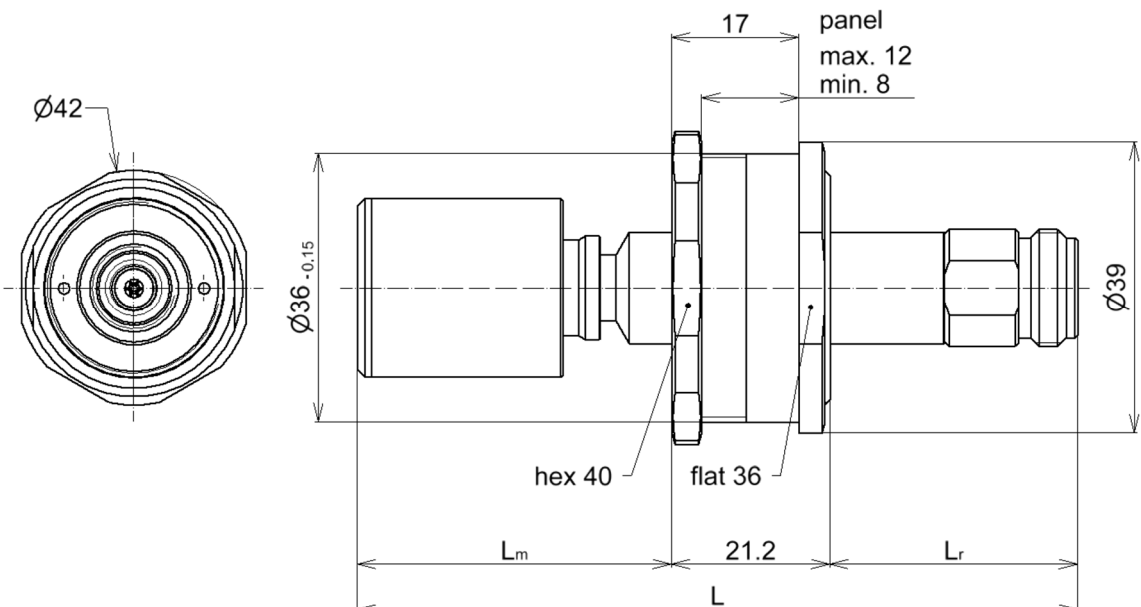

All dimensions in millimeter

Calculation of total length:

$$L = 21.2 + L_m \text{ (length of measurement interface)} + L_r \text{ (length of rear interface)}$$

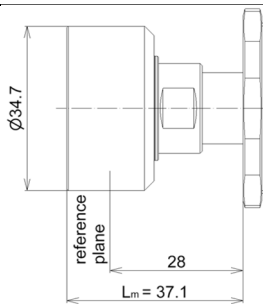
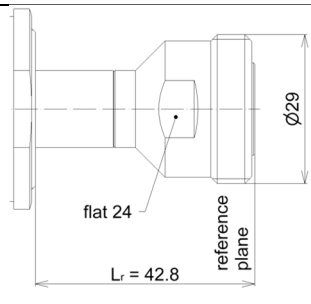
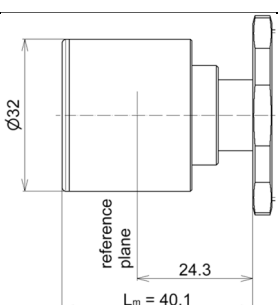
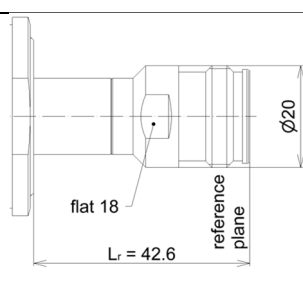
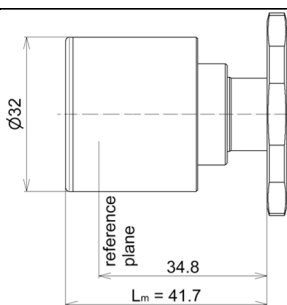
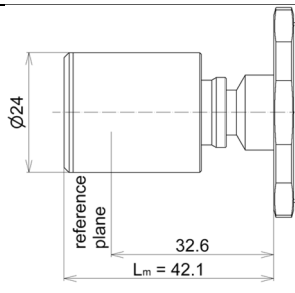
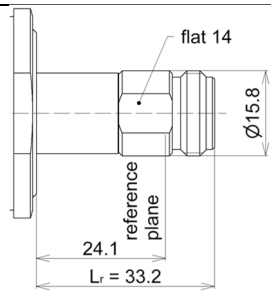
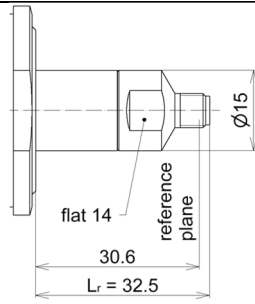
| Connector variants | | |
|---|---|---|
| | Measurement interface | Rear interface |
| 7-16 (50 Ω) per IEC 61169-4 |  |  |
| | 7MP | 7F |
| 4.3-10 (50 Ω) per IEC 61169-54 |  |  |
| | 43MP | 43F |
| 4.1-9.5 (50 Ω) per IEC 60169-11 |  | |
| | 41MP | |
| N (50 Ω) per IEC 61169-16 |  |  |
| | NMP | NF |
| 3.5 mm (50 Ω) per IEC 60169-23 | |  |
| | | 35F |