

Cable Plug for LF 7/8"-50, Type 7-16 || BN 854302

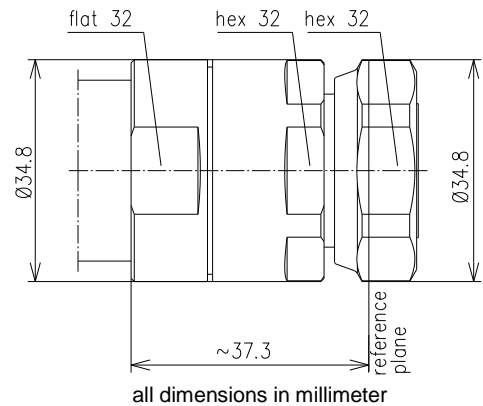

SPINNER GmbH
 This document is proprietary to us.
 All rights reserved. Any use, transfer, or reproduction of this document
 or the know-how contained therein requires our express consent.

| | | |
|--|---|---|
| Interface type | 7-16 plug (50 Ω) per IEC 61169-4 | |
| Version | MultiFit | |
| Frequency range | DC to 3.8 GHz | |
| VSWR, max. / typ. | 1.02 @ DC to 1.0 GHz 1.03 @ 1.0 to 2.7 GHz 1.08 @ 2.7 to 3.8 GHz | |
| Inner conductor material / surface finish | copper alloy / silver plated | |
| Outer conductor material / surface finish | copper alloy / CuSnZn plated | |
| Other metal parts / surface finish | copper alloy / Sn plated copper alloy / CuSnZn plated copper alloy / nickel plated | |
| Insulation | PTFE | |
| Sealing | silicone rubber | |
| IP protection level | IP68 per EN 60529 (barrier and mating face sealed) | |
| Cable compatibility | SPINNER Acome Andrew Draka Eupen Hansen Hengxin Leoni LS Cable RFS | SPINNERFlex™ LF7/8"-50 HPL50-7/8 ALU, HPL50-7/8 F, HPL50-7/8 LA AL5-50, AVA5-50, VXL5-50 RFA 7/8"-50, RFA 7/8"-50 AL, RFE 7/8"-50 EA5-50 Aluminium, EC5-50-A, EC5-50-HF RF 50 7/8" HCTAY-50-22 FlexLine 7/8" R Low Los LHF 22D, HFC 22D LCF 78-50 A, LCF 78-50 L, UCF 78-50 A, UCF 78-50 L |
| Installation instructions / Product manual | M32110 | |
| Weight, approx. | 140 g | |
| Scope of delivery | installation instructions | |